

# PURO DUO

- pure simplicity and unpretentious elegance are what distinguish these baths
- bathing with a friend: two identical back rests and centrally positioned waste
- classic four-cornered model
- made of Kaldewei steel enamel 3,5 mm

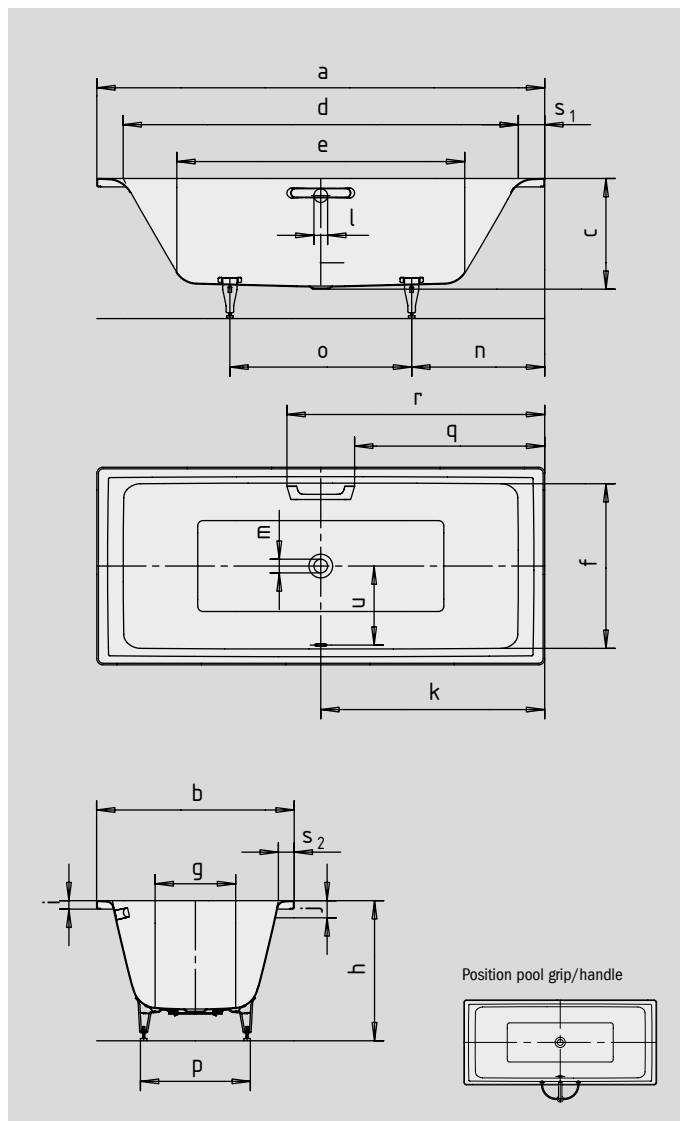

Similar illustration



ELEGANT PURISM AMBIENTE COLLECTION

COMFORT SELECT



Model No.		663	664	665
External length	a	1700	1800	1900 mm
External width	b	750	800	900 mm
Depth	c	420	420	420 mm
Internal length (top)	d	1500	1600	1700 mm
<b>Internal length (bottom)</b>	<b>e</b>	<b>1020</b>	<b>1120</b>	<b>1220 mm</b>
Internal width (top)	f	630	680	780 mm
Internal width (bottom)	g	460	510	615 mm
Height with feet	h	540-575	545-572	540-575 mm
Height of rim	i	32	32	32 mm
Distance top edge to centre of overflow hole	j	65	65	65 mm
Distance bath edge (foot) to centre of drain hole	k	850	900	950 mm
Diameter of overflow hole	l	52	52	52 mm
Diameter of drain hole	m	52	52	52 mm
Distance foot end of bath edge to centre of foot	n	545	535	585 mm
Distance between the feet	o	605	730	730 mm
Max. width of feet	p	465	510	605 mm
Distance bath edge (foot end) to where grip/handle starts	q	722	772	822 mm
Distance bath edge (foot end) to where grip/handle ends	r	978	1028	1078 mm
Width of rim (foot end; head end; lengthwise)	s <sub>1</sub> ; s <sub>2</sub> ; s <sub>3</sub>	100; 60	100; 60	100; 60 mm
Distance between centre holes	u	305	330	380 mm
Water volume** in litres		122	165	217
Weight of the enamelled bath in kg		48	54	61
Anti-slip		348 x 348	348 x 348	348 x 348 mm
Full anti-slip		876 x 252	924 x 348	1020 x 396 mm

Subject to technical alterations, tolerances and errors. Similar illustration.  
 \*\* 70 litres displacement on average.