

# KUDOS

REFRESHING INNOVATION IN SHOWERS

## ORIGINAL RANGE CORNER SLIDER DOOR Installation Instructions

Please read these instructions before installing, as incorrect fitting will invalidate the guarantee. Carry out each stage before moving onto the next. **Do not dispose of packaging**, no claims for missing or damaged parts will be accepted if the packaging has been disposed of. If you are unsure about these instructions please contact Kudos Shower Products:  
**Customer Service Helpline: 01539 564040**

### TOOLS REQUIRED

- Flat-Headed Screwdriver
- Pozi-Drive Screwdriver
- Spirit Level
- Tape Measure
- Silicone Sealant
- 4mm & 2.5mm Allen Key (Supplied)
- Electric Drill
- 7mm Drill Bit (Masonry)
- Scissors
- Lubricant (vaseline)

### KEY STAGES

- Slide stop blocks to one side
- Slide fixed panels to one side
- Insert height adjusters
- Join both doors using corner mouldings
- Position and mark unit onto walls
- Fix unit to walls
- Adjust wall post so that level and straight
- Fix panel glass into place & fit seals
- Hand sliding door if needed and fit
- Fit all cover caps and silicone seal

### IMPORTANT

Check appearance of shower enclosure - any defects must be reported to Kudos Shower Products before assembly/installation. Claims for imperfections will only be accepted prior to assembly/installation.

Any claims made under the terms of the Lifetime Guarantee must be reported to Kudos within 21 days of the fault occurring.

Check the enclosure adjustment sizes are suitable for your installation.

Ensure the top of shower tray is level in all directions.

Prior to tiling, any gap or crevice between the rim of the tray and the wall must be filled with silicone sealant flush with the rim of the tray - **see Fig.1**

Waterproof the walls using ceramic tiles/shower panels etc. before installation of the shower enclosure.

Fully seal between tiles/shower panels and the tray **BEFORE installing the enclosure - see Fig.2**

Use care when drilling into the walls to avoid hidden pipes or electric cables.

Once the tray is installed but **before** the tiles are fitted any crevice between the tray and the walls **must** be filled with silicone sealant flush with the top of the tray.

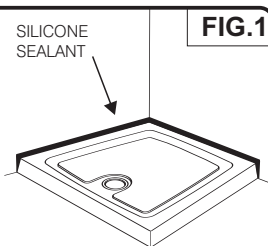

Once the walls have been tiled but **before** the enclosure is installed, the tiles **must** be silicone sealed to the tray all of the way around in one continuous bead.

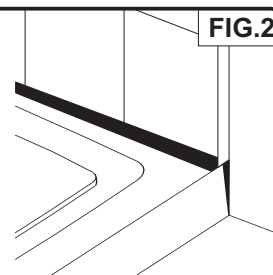

### CLEANING

**GENERAL** - for the frame work and fixings use only warm soapy water and damp cloth/ sponge on a regular basis. After cleaning please rinse with clean water to remove any residue.

Do not use abrasive scouring powders, chemicals or aerosol cleaners - these may result in damage to the surfaces, in particular, the plated component parts. **See instruction below for glass cleaning advice.**

### LIFESHIELD

**Your Kudos Product** is pre-treated with Life Shield on the inside surfaces only. While this makes cleaning the glass a lot easier and helps prevent the build up of harmful lime-scale and soap deposits the glass still needs to be maintained on a regular basis. We recommend the use of a detergent and aroma free glass cleaner (A 50/50 mix of Vinegar and Water works well!!!) Strong detergents and abrasives can damage the coating.

**DO NOT** use abrasive cleaners or abrasive scrubbing equipment for cleaning!!

**DO** use a squeegee to remove remaining droplets of water from glass after showering, any build up of residue can be removed easily using an appropriate cleaner and agitation from soft cleaning equipment

**THESE INSTRUCTIONS TO BE LEFT WITH THE CUSTOMER**

**IMPORTANT- when fitting this product please ensure that the ROLLER BEARINGS on each sliding door MUST BE fitted to the TOP of the enclosure**

- ① Lay one side of the door flat on a protective surface with the **inside** face of the door facing upward. Using 2.5mm allen key supplied, loosen grub screws in door stops in the top and bottom rails and slide these towards the wallposts.

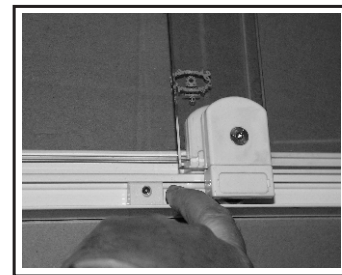
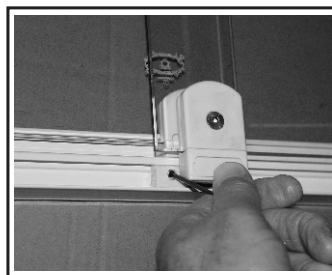

- ② Remove the screws that secure the two patch fittings of the fixed panel to the door frame, at the top and bottom of the door. (Note - only the two patch fittings nearest to the wallpost, not the patch fittings that are behind the sliding glass door). Slide the fixed panel towards the centre of the frame away from the wallpost - ensure the rigid gasket on the edge of the glass remains securely clipped onto the glass edge.

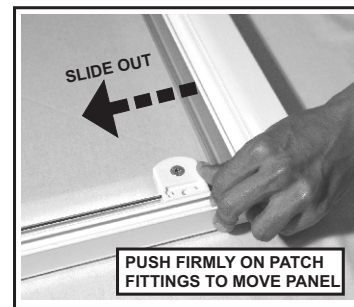
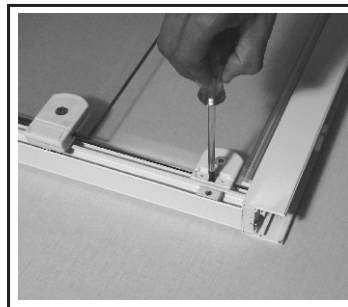

- ③ Remove the clip-in extrusion from the inside face of wallpost by lifting up along entire length then lifting away and out as shown.

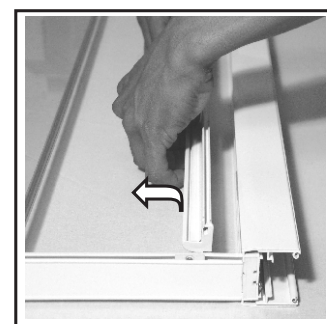
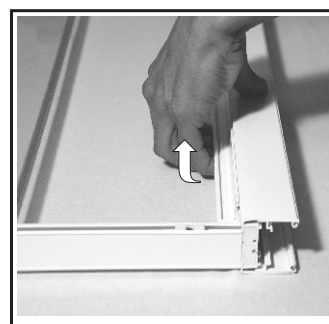

- ④ Repeat above stages for the second half of the door

- ⑤ Insert height adjusters into the bottom of each wallpost.

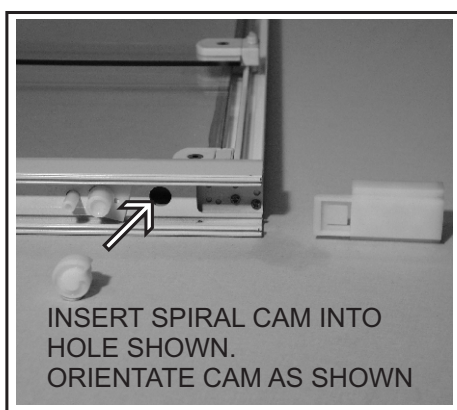

- ⑥ Insert corner junction pieces into the top and bottom horizontal door rails and secure with No.6 x 10mm long panhead screws provided. With the two halves of the door in the vertical position, offer the other half onto the corner junction pieces and screw together with screws provided.

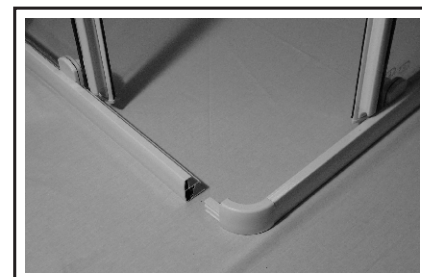
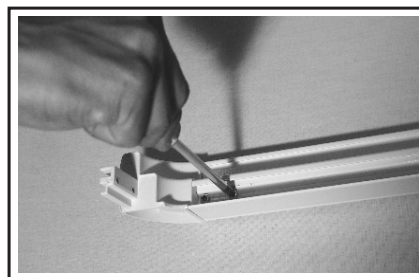
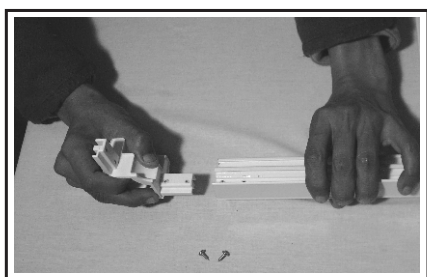

- 7 With utmost care, (to prevent possible damage to the corner junction pieces) offer unit onto the tray and plumb the door frame on both sides by turning the nylon adjustment screws - 3 in each wallpost. Turning these screws in an anti-clockwise direction will expand the wallpost if required to take up any inaccuracy in the plumb of the wall and ensure the wallposts are vertical.

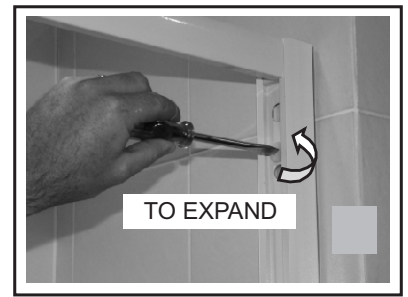

- 8 Set door level on tray by turning relevant height adjuster screw (clockwise to raise) if necessary. Use a spirit level to ensure accurate levelling. (Note: if the tray dips down to the external corner it may be necessary to pack under the corner junction to ensure frame is level).

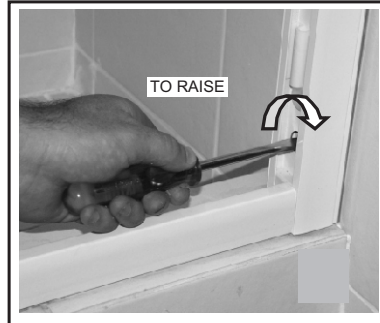

- 9 Using spirit level to ensure wallposts are vertical, mark through holes in wallpost mouldings - 3 in each wallpost.



- TIP** To mark holes through wallposts, dip a drill bit in nail polish and "spot" the position through the wallpost mouldings.

- 10 Drill holes in walls using 7mm masonry drill and fit wall plugs supplied, or fixings suitable for the construction of your walls.

- 11 Carefully re-position door onto tray and fix to walls using six-No. 8's x 60mm long

Check wallposts are vertical, if not, remove wall-fixing screws and remove plastic insert from mouldings (using fixing screw). This will leave a slot in the moulding in which you can adjust the wallpost to vertical.

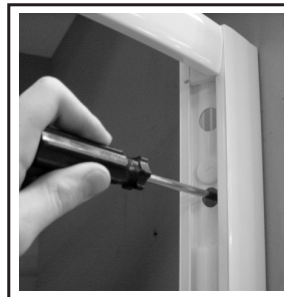

**IMPORTANT** - ensure wallposts are vertical and straight using adjustment screws as described at stage 7.

- TIP** Use clip-in extrusions as straight edges to ensure wall posts are straight.

- 12 Re-fit clip-in extrusions, which were removed at stage 3, (curved face to outside of unit). Ensure the clip-in extrusion is re-inserted correctly. Do make sure the leading edge is properly located along full height before pressing the clip-in extrusion into the doorpost, it will not locate properly if twisted.

- 13 Slide fixed panel back to the wallpost, ensuring the 'lip' on the rigid plastic seal slots **fully home** into the **groove** on the clip-in extrusion along its **entire length**. Failure to insert this correctly may result in the panel leaking. Secure panel in place by fixing top and bottom patches to rails using the two 6's x 20mm long panhead screws removed at stage 2.

To ease sliding action, loosen the patch fitting screws, slide across, then re-tighten screws.

To align hole in patch fitting with hole in rail, loosen patch fitting screw and move patch independently to align.

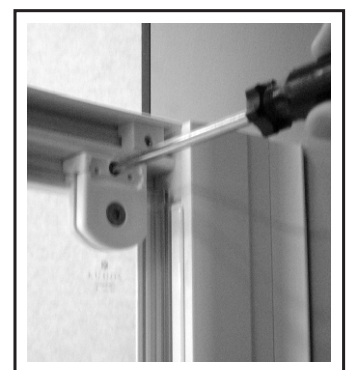

- 14 Slide the doors to meet each other at the corner. The magnets should be in contact with each other along their entire length. If not the doors can be adjusted as described at the following stage.

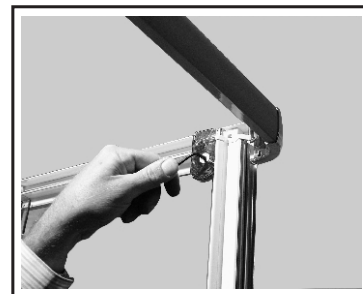

- TIP** Lubricate bottom rails by applying vaseline/lubricant spray to running channels to ease sliding action.

- 15 ADJUST HANGING OF DOOR, there are two methods to adjust the hanging of the door, A and B.

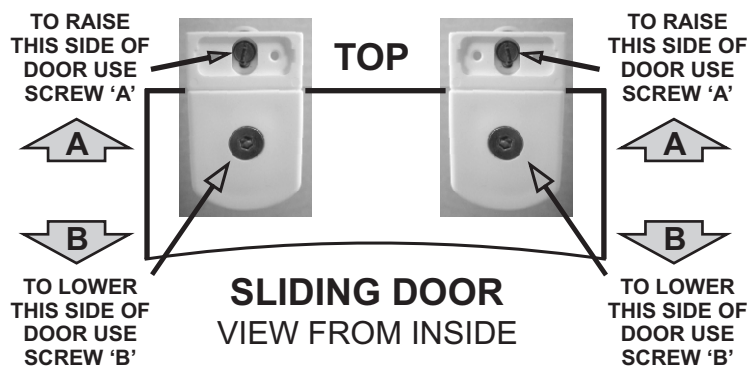

**PLEASE ENSURE THAT AFTER ADJUSTMENT ALL SCREWS ARE FULLY TIGHTENED**

- A** **Roller bearing adjustment-** using screwdriver, loosen screw (*do not remove*), re-position screw in slot and re-tighten.

- TIP** Use foot to support door when adjusting.

- B** **Patch fitting adjustment-** using allen key, loosen screw (*do not remove*), lower glass and re-tighten.

- 16 Using 2.5mm allen key, position and fix the 'sliding-door' stops in the top & bottom rails. This will prevent the sliding doors from banging into the fixed panels and corner junction pieces, if excessive force is used when operating doors.

- 17 **FIT GLAZING SEALS** to fixed panel glass on outside of unit. Insert long length between clip-in extrusion and glass. Insert short lengths between top and bottom rails and glass at top and bottom, in-between patch fittings.

- TIP** If tight, lubricate seals with water. Do not stretch seals when inserting-after cutting, the seals will shrink and leave a gap.

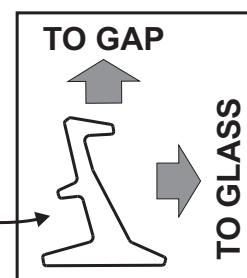
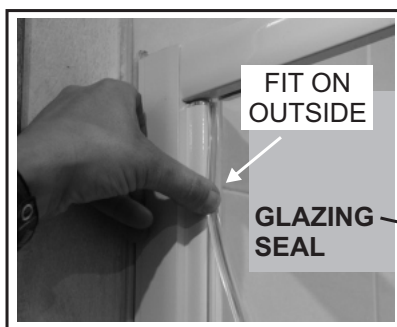

- 18 Fit cover caps, to all patch fittings and each wallpost. Secure wallpost cover caps using No.4 x 10mm long screws provided.

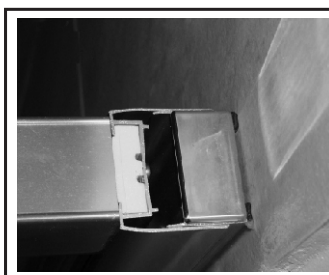

- 19 Silicone seal unit to walls and tray.

**IMPORTANT**

**Do not silicone seal on the inside of unit** (except where shown).

Sealing the wallposts & rails to the tray on the inside can result in leakage problems-please note that, in use, water can penetrate into the frame extrusions-*this has no detrimental effect to the product*-however, this water must be allowed to drain out of the extrusions to the inside.

**Allow 24 hours for the silicone to cure before using the shower.**

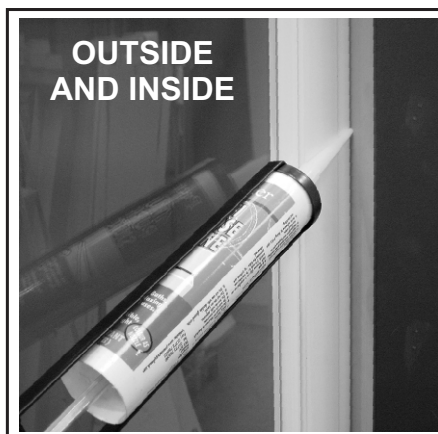

Silicone seal wallposts to wall on inside & outside



Silicone seal frame to tray and joints as shown