

for **Concept Shower Trays**
Installation Instructions

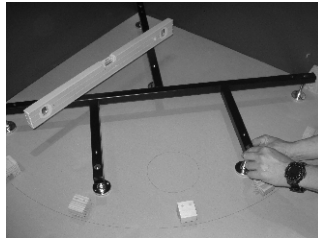

easi-level

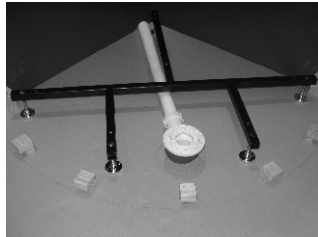

easi-plumb

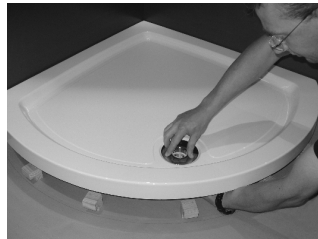

easi-access

Please read carefully before commencing installation

The CONCEPT 2 plinth has been designed for use with CONCEPT 1 and 2 trays. Whilst the plinth may be suitable for use with other trays, KUDOS makes no warranty as to its suitability and accepts no responsibility for problems arising.

Ensure the floor surface where the plinth will sit is secure, with no movement evident.



1
Position the tray into place tight against the walls. Using the tray as a template, mark the position of the waste hole and front perimeter for the fascia panel. We advise waste hole be positioned at front for easy access.

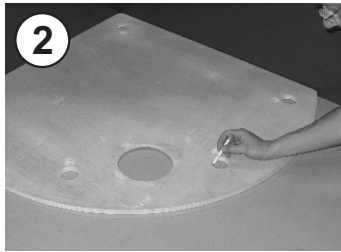

2
Position baseboard so that it is equally spaced between the walls and the front perimeter line. Ensure waste hole sits over the template drawn on the floor and mark the position of the plinth feet (through the 45mm dia. holes).

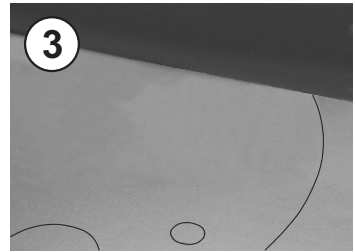

3
Remove baseboard ensuring all lines are clearly visible.

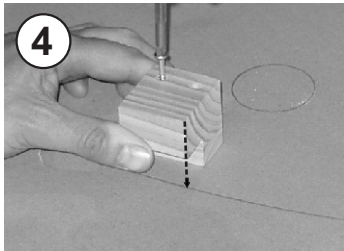

4
Fit floor mounted 'L' shaped blocks to perimeter line using appropriate fixings for your floor construction. **The block needs to be set back from the line as shown, with the outermost edge reaching to the perimeter line drawn.**

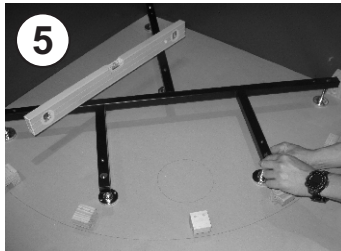

5
Attach adjustable feet, with locknut placed half-way down leg. Set height from floor to top of frame to 92mm (110mm with board). **This allows enough space for the moulded fascia, which measures approximately 107mm in height.**

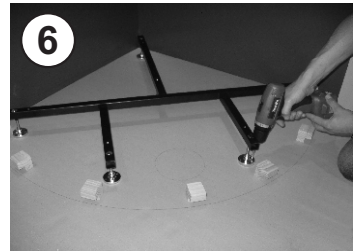

6
Check level and that correct height is set. Adjust legs if necessary before tightening locknuts to secure. Fix feet to floor using appropriate fixings for your floor construction.

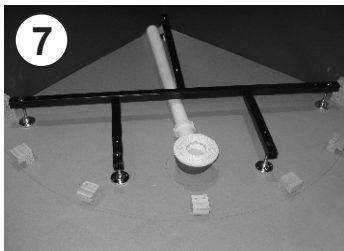

7
Position trap to markings and connect waste pipe.

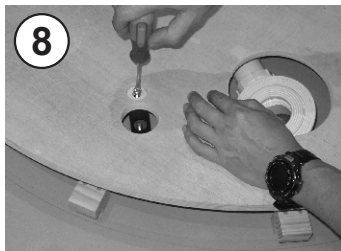

8
Fix baseboard to plinth using the engineering screws and washers provided.

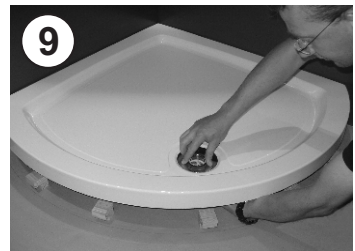

9
Fix tray to baseboard on a bed of sand & cement or cement-based tile adhesive (not ready mixed adhesive). The tray may overhang the board slightly. Connect waste to trap following the instructions supplied for this.

ADDING THE FINISHING TOUCHES TO YOUR PLINTH AND TRAY

SQUARE, RECTANGULAR AND PENTAGRA MODELS

Cut and fit skirting, securing to the floor mounted blocks and baseboard (which may require packing out). Seal top against tray with a thin bead of silicone sealant. Paint or stain as required.

Alternatively, use hardboard and tile edging strip to provide an easy to tile panel. Secure to the baseboard and floor mounted blocks. Again, seal top against the tray with a thin bead of silicone sealant.

NOTE

Concept 2 square and rectangular plinth boards have their waste hole cut midway along the straight edge and in the corner. The hole in the corner was to suit the Concept 1 trays, which have been discontinued, and therefore in most instances is not required as Concept 2 trays have their waste hole placed along the straight edge.

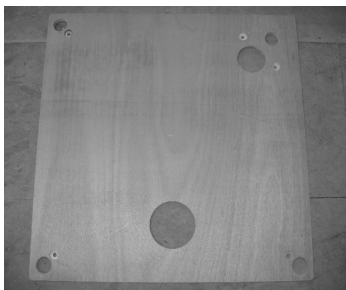

Concept 2 plinth board with both waste holes drilled



Concept 1 tray with waste hole in the corner



Concept 2 tray with waste hole midway along the straight edge

FITTING MOULDED PANEL SUPPLIED FOR CURVED AND BOWED MODELS ONLY



Recognising the difficulty in fitting skirting or tiling around a curved tray we supply a moulded panel

Fitting the moulded fascia supplied

The showertray needs to be set to 110mm, giving 3-4mm allowance for the moulded panel. Panels are unhandso so will require trimming with a fine tooth saw. 5mm diameter pilot holes need to be drilled in facing edge of Plinth Baseboard above 'L' shaped blocks and Nylon Adjusting Screws positioned to help support top of moulded panel. Secure panel in place with 20mm screws and cover caps provided (a 4mm hole may be needed for the screw in the 'L' shaped blocks). The side panel, if required, is designed to interlock behind the front panel.