

Installation Guide

MB5A Curtain Rail Bath screen

IMPORTANT

Please read the complete instructions
before commencing fitting.

Do Not attempt to install the product unless you can tick all 4 boxes satisfactorily

- Check that you have the tools required
- Check the installation site is compatible with the sizes of door supplied
- Check all the enclosure components are present
- Check the installation kit is complete

The wall plugs supplied with the installation kit are for use in solid walls. Hollow or 'stud partition' walls will require alternative fixings. Please consult a hardware supplier for the correct type. It may also be necessary to consult your tiling supplier about the correct method for drilling your tiles

**ATTENTION: TAKE EXTREME CARE WHEN HANDLING GLASS.
WEAR PROTECTIVE EYEWEAR AND CLOTHING.
DO NOT LEAVE THE GLASS ON HARD SURFACES AND AVOID
CONTACT BETWEEN THE GLASS EDGES AND HARD SURFACES OR
IMPACTS DURING THE INSTALLATION**

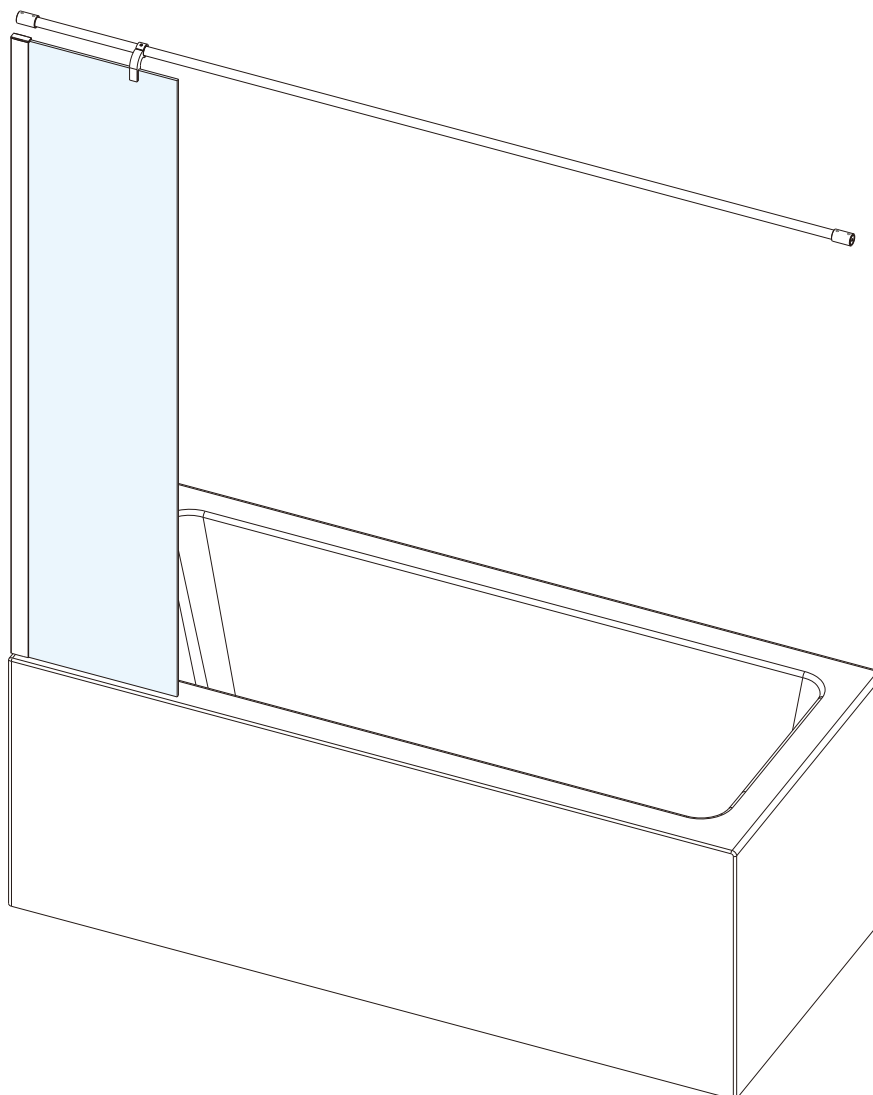

COMPONENTS AND BOX CONTENTS

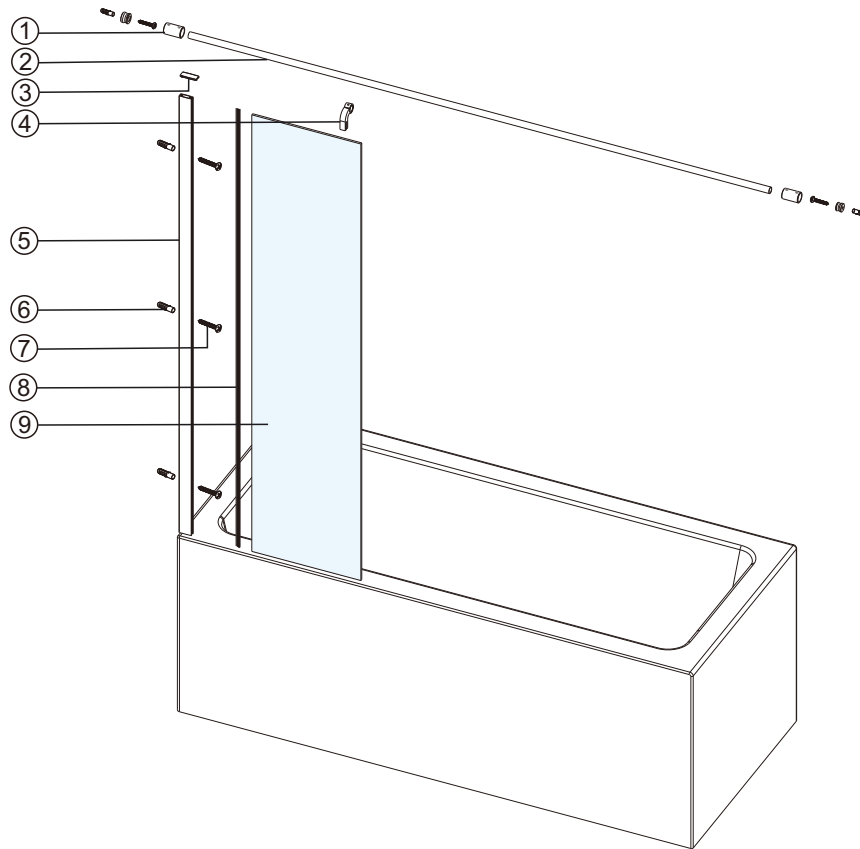

No.	Description	Qty	Part No.	No.	Description	Qty	Part No.
1	Wall bracket	2	MOBY023	7	Screw(4X40mm)	5	A2403001
2	Rail	1	MOBY022	8	Wedge seal	1	K165
3	Wall profile cover	1	K015	9	Glass Panel	1	A
4	Glass Bracket	1	S033C				
5	Wall Profile	1	MOBY021				
6	Wall Plug	5	2SP12				

Fixing Kit components

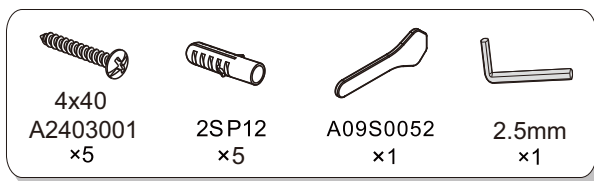

Tools required

- 6mm Masonry drill bit
- Power drill
- Quality silicone
- Pencil
- **Tape measure**
- PH2 Philips Head screw driver
- Spirit level with horizontal and vertical level indicators

IMPORTANT - Installation Site

1. Ensure your bath is level before fitting. This screen is not designed to fit on baths with stepped fronts, roll top rims or integral soap dishes.
2. The tiling or other wall finishing should be effectively sealed at the bath edges.

INSTALLATION

1. Position the wall profile **MOBY021** so the fixed panel A sits on the inside edge of the bath. Fig 1

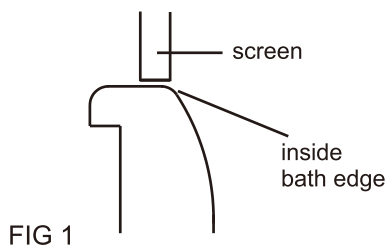

2. Plumb the wall profile **MOBY021** using the vertical element of the spirit level. Mark 3 holes, drill with 6mm masonry bit and fit wall plugs **2SP12**. Using the 3 Screw **A2403001**, fix wall profile to wall. Fig 2.

3. Insert glass panel into the wall profile. Note: Max. adjustment of the glass panel in the wall profile is 20mm. Fig 3

4. Insert wedge gasket to the inside of the wall profile using **K165** Start at the bottom, pushing the seal in fully. Fig 4

FIG 2

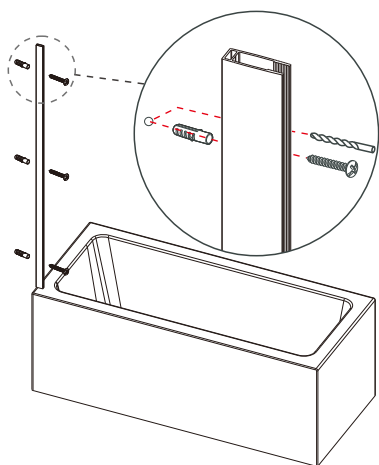

FIG 3

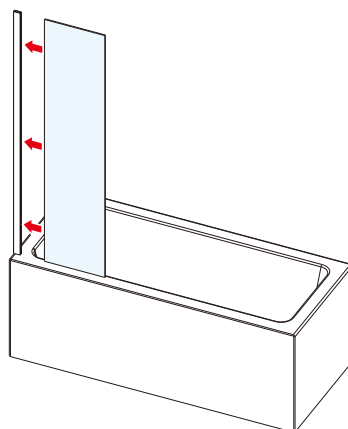
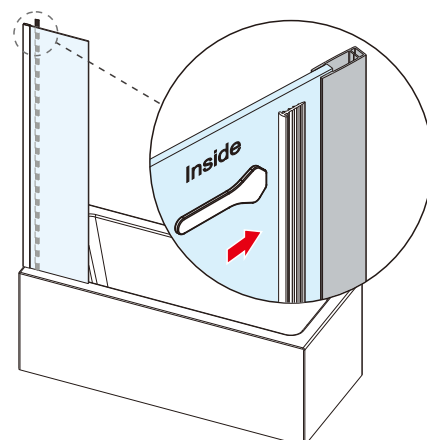
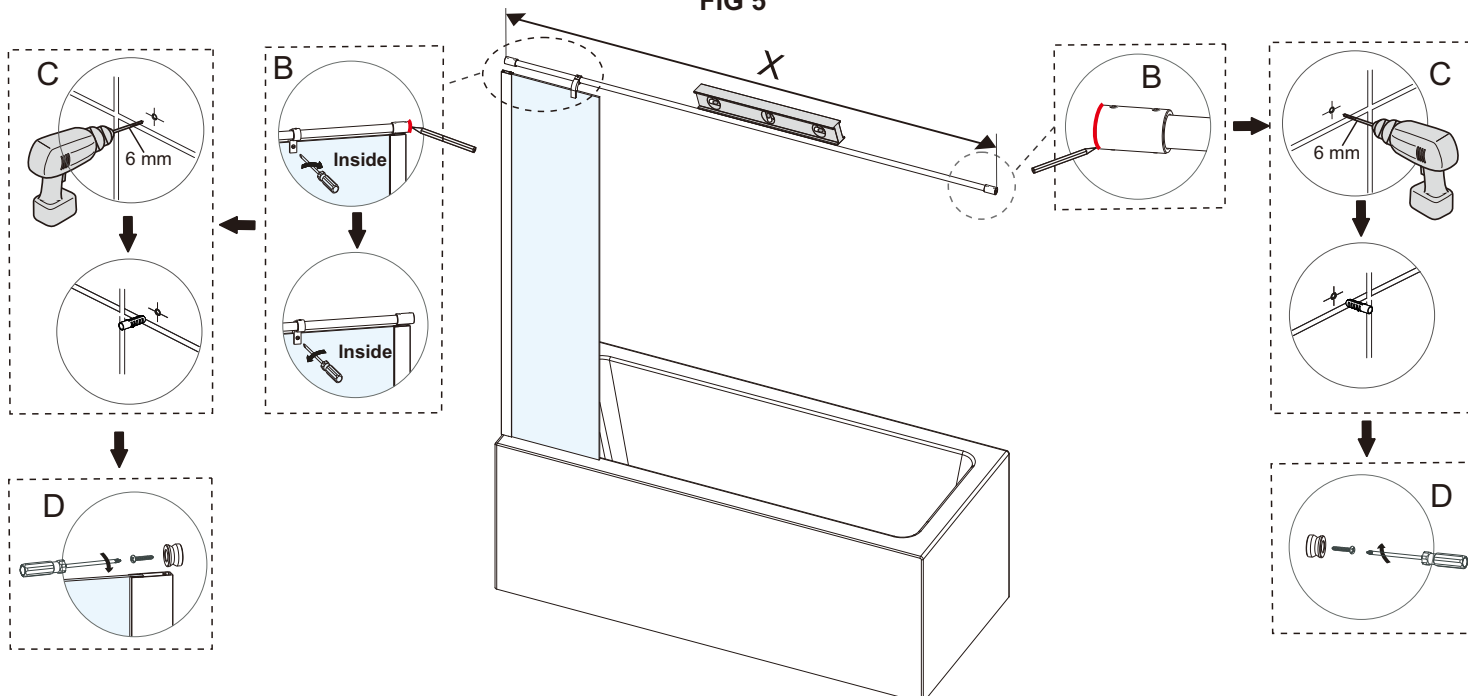

FIG 4



5.
 - A. Measure the distance 'X' from wall to wall where the rail is to be fitted and cut the rail 30mm less.
 - B. Slide the glass bracket, then both wall brackets onto the rail. Fit the glass bracket onto the top of the glass panel. Level the rail while ensuring it is parallel to the bath edge then mark the wall around the ends of the rail. Remove the rail.
 - C. Drill holes with 6mm masonry bit, insert wall plugs **2SP12**.
 - D. Fix the wall plates.

FIG 5



6. Place the rail back in position over the glass panel. Slide both wall brackets over the wall plates and tighten all grub screws. Position the glass bracket approx. 50mm from the edge of the glass panel and tighten both grub screws.

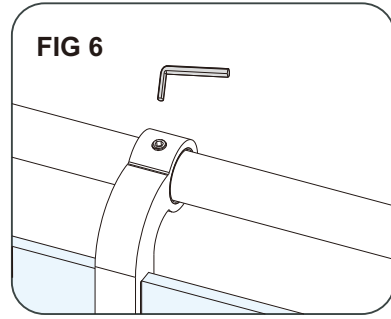
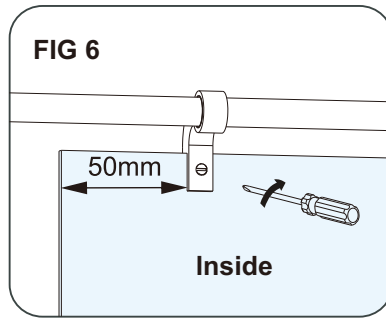
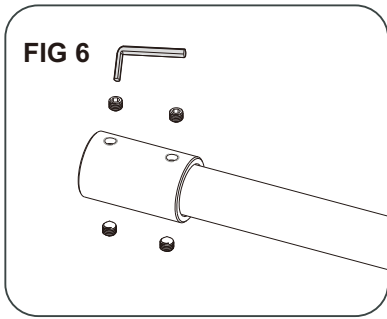

7. Fix the wall profile cover K015.Fig7.

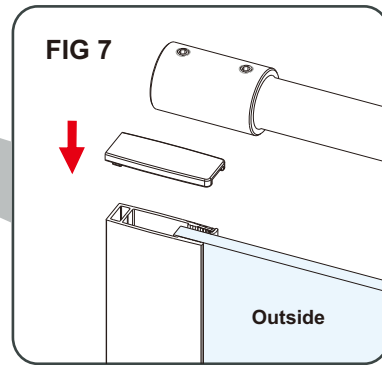
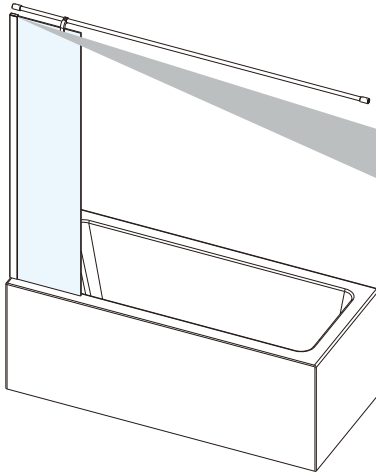

Sealing. Fig8

Inside
Seal between the wall and the wall profile.

Outside

Seal between the wall and the wall profile.
From the base of the frame seal approx. 50mm between the joint of the wall profile and the glass.
Seal between the bath edge and the bottom of the profile and glass panel.

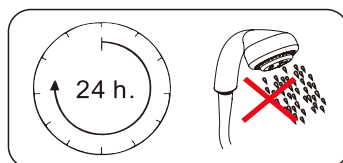
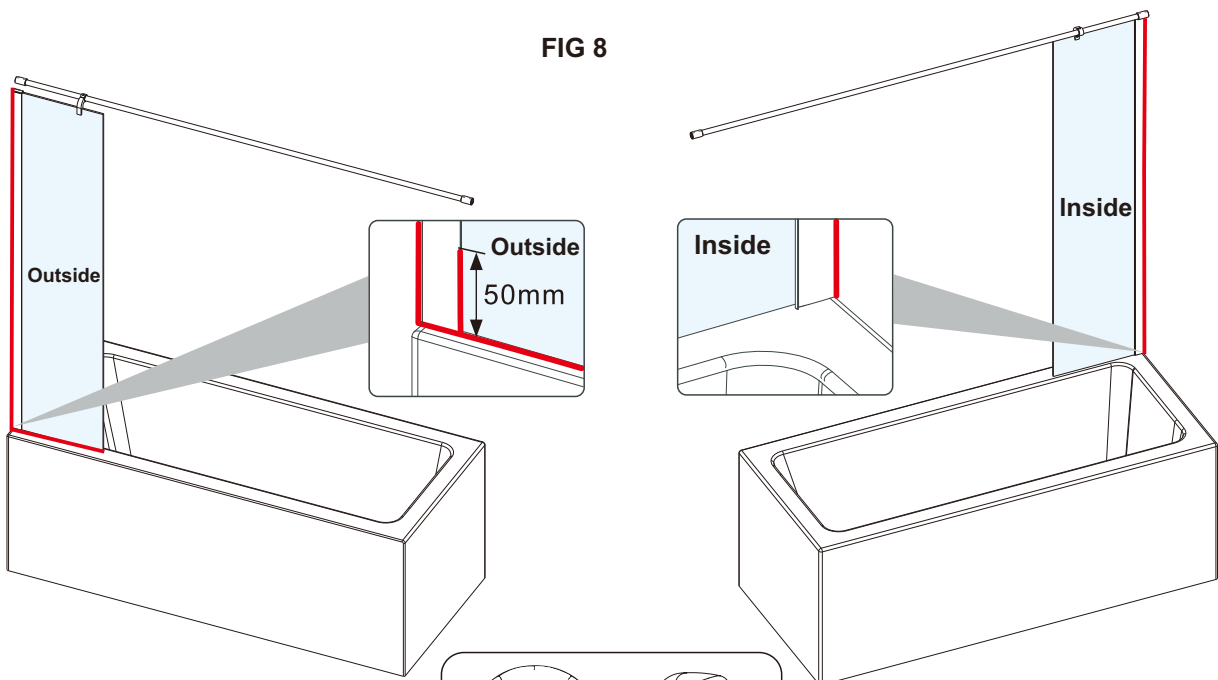



UK Distributor:
Merlyn
(a division of NGHL),
Ladyfield House,
Station Rd, Wilmslow,
Cheshire, SK9 1BU.

Manufacturer:
Merlyn Industries Limited,
Unit 8, Purcellsinch Ind.
Estate, Kilkenny,
Ireland,
R95 HP71.

12

UKCA DOP: UKCAMOBS1.0
CE DOP: CEMOBS1.2

MB5A (MER14)

PH

EN 14428

CA/IR/DA