



## **AFTERCARE INSTRUCTIONS**

The replacement handles have a high quality finish and should be treated with care to preserve the visible surfaces.

All surface finishes will wear if not cleaned correctly, the only safe way to clean them mixer is to wipe with a soft damp cloth. Stains can be removed using washing up liquid. All bath cleaning powders and liquids will damage the surface finish even the non-scratch cleaners.

## **GUARANTEE**

All products are manufactured to the highest standards and a 5 year guarantee covers any defect in manufacture.

In the interests of continuous product development we reserve the right to alter specification as necessary

## **TELEPHONE HELP LINE! 0844 701 6273**

Bristan Group Ltd.  
Birch Coppice Business Park  
Dordon  
Tamworth  
Staffordshire  
B78 1SG  
UK

A Masco Company

Web Site: [www.bristan.com](http://www.bristan.com)

Telephone: 0844 701 6274

Facsimile: 0844 701 6275

Email: [enquire@bristan.com](mailto:enquire@bristan.com)

(FI BASIN REVIVER)

(Rev. D3)

# **Basin & Sink Reviver Kit**

## **Fitting Instructions & Contents List**

**Please keep these instructions for future reference and request of replacement parts.**

## CONTENTS

2x Tap Handles (& valve covers if period style)  
 2x Valves  
 4x Blue Spacer Washer  
 2x Small Screw  
 2x Medium Screw  
 2x 1/2" 1010 Tap Inserts

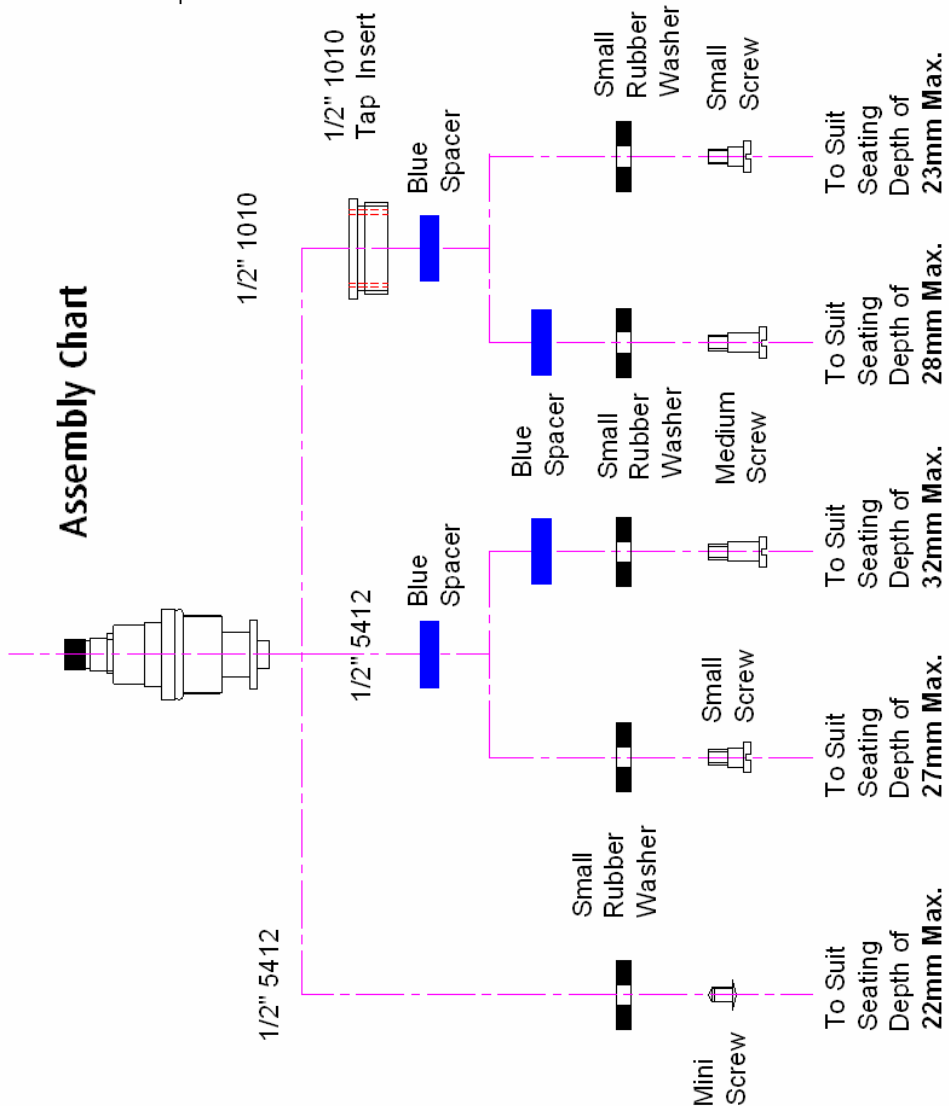

## INSTALLATION

1. Identify all components and check pack contents for completeness, particularly before arranging fitting.
2. Isolate the water supply to the taps/ mixer and open the valves to drain any water from the body.
3. Take off the existing handles and remove the valves (unscrew anticlockwise using the correct sized spanner). Take care that the body of the tap/mixer does not turn, which may disturb the connection to the pipework.
4. Try the valve in the body. If the thread fits it is a BS5412 tap follow flow chart on 1/2" 5412 section.
5. If the thread in the body is too large, then the taps/ mixer are BS1010 follow flow chart on 1/2" 1010 section.

**Note: The Tap inserts must be fitted to the valve with the nut uppermost before the fitting of the spacer washers.**

6. Measure the seating depth (\*) of your tap/ mixer and then see the assembly chart to determine which spacers are required.
7. Remove the Mini screw from the valve and remove the rubber washer from the base of the valve. Fit either 1 or 2 of the blue spacers depending upon the seating depth of your taps/ mixer and then re-fit the rubber washer to the base of the blue spacer/s using the appropriate length screw to hold the assembly together.
8. Tighten the valve into the tap body taking care not to over tighten.
9. Fit the tap head to the valve and turn on and off a few times to check the action before turning on the water. Secure the head with the screw and fit indice / bezel.

**Note: On the lever kit it may be necessary to adjust the gland nut (Small nut of the valve) to improve the shut off, to suit the water supply pressure and usage.**

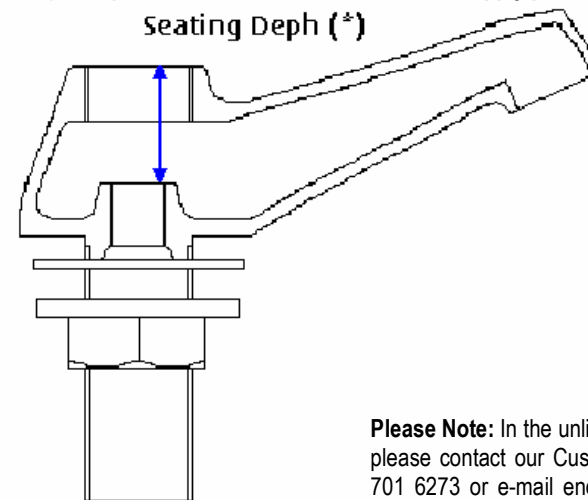

**Please Note:** In the unlikely event you find a part missing please contact our Customer Service Help line on 0844 701 6273 or e-mail [enquire@bristan.com](mailto:enquire@bristan.com) for immediate dispatch of part.